

Hangaren

Technical Specifications

Albyvägen 38, 145 59 Norsborg



Description

With its impressive 2150 sqm open space, Hangaren is our largest studio. The former timber warehouse, beautifully situated next to the shores of Albysjön, has been renovated and rebuilt to suit various types of events and activities. Hangaren can be used in its entirety or divided, which provides for flexible solutions.

In direct connection to Hangaren is the Production House, which with its 16 lodges, reception, production office, meeting room, kitchen and laundry room functions as a service house and backstage area to Hangaren.

Area

2 500 sqm, of which 2 150 sqm open space

Maximum number of people

2 500 standing,
900 seated in stands

Facilities

Handicap accessibility, gated area, Wi-Fi, toilets, parking, kitchenette

Subtopia



Floor

- Floor space 2 500 sqm.
- Open space for building 2 150 sqm.
- Max length 72 m.
- Max width 35,5 m.
- Floor load max 3 tons / sqm.
- Gray epoxy surface, concrete, not paintable.
- Two floor drains.

Ceiling

- Sloping roof 6-8 m.
- Ceiling color black and gray.
- Sound attenuation Ecophone.
- Glulam beam 6 m c / c.
- Fixed attachment points maximum load 300 kg.
- Fluorescent lamps in sections A, B, D, E, F.
- Decorative lighting (section B).

Section C

- Space 17,4×17,4 m.
- Rig beam 12,7 m.
- Sound attenuation: black Ecophone.
- Spiral staircase to the ceiling.
- Catwalk along rafters.
- Total load: max 32 tons.
- Point load: 2 tons.
- Fluorescent lamps (section C).
- Fastening points in the floor.
- Smoke hatches 2 pcs.

Walls

- Sound attenuation: light gray Ecophone.
- 3 cargo gates on the ground floor, 4.2 × 4.2 m:
Port 1, Port 2, Scenport
- Rail with black fabric separation between middle part and side surfaces that frames approx. 750 sqm (section C + D).
- Cable hatch (section F).
- 2 water drains (section B + D).
- Heating elements along the walls.

Electricity

- Section C 1 × 32 A, 2 × 63 A.
- Electricity room 1 × 32 A, 3 × 63 A, 1 × 125 A.
- Powerlock 2 × 200 A.

Waste fractions

- Household waste 2 pcs 660 liters (emptying Tuesdays).
- Container, combustible 10 kbm (when ordering).

Technical equipment (extra order)

- Reach truck with passenger basket.
- Scissor lift, working height 13 m.
- Truss and rig equipment.
- Stage, modular 18 × 14 m.
- Podium-built grandstand, 600 pl + 150 pl + 150 pl.

Other (extra order)

- Exhibition mats black, 1 × 1 m (max. 600 sqm).
- Chairs, black upholstered, 850 pcs.
- Folding table, 180 × 80 cm 20 pcs.
- Standing table, 30 pcs (with black sock).
- 5 Wardrobe racks on wheels.

Security

- Fenced area.
- External surveillance is handled by security companies (extra surveillance can be ordered).
- Motion alarm.
- Smoke detector.
- 22 emergency exits.

Facilities

- Main entrance for audience, 4 entrance doors.
- Stage office (floor 1) 2 dressing rooms with kitchenette, WC and shower (section E).
- Pacemaker 1 pc (section E.)
- WC women 6 pcs, men 3 pcs (section A).
- Urine 3 pcs (section A).
- RWC 1 pc (section A).
- Wi-Fi.
- Ticket office.
- Door to Produktionshuset, backstage (section E).

Parking

- Fenced area about 25 cars.
- Open parking (parking disc 8 hours) 90 places, and 3 places for the disabled.
- Paid parking 80 places.

Floor plan Hangaren

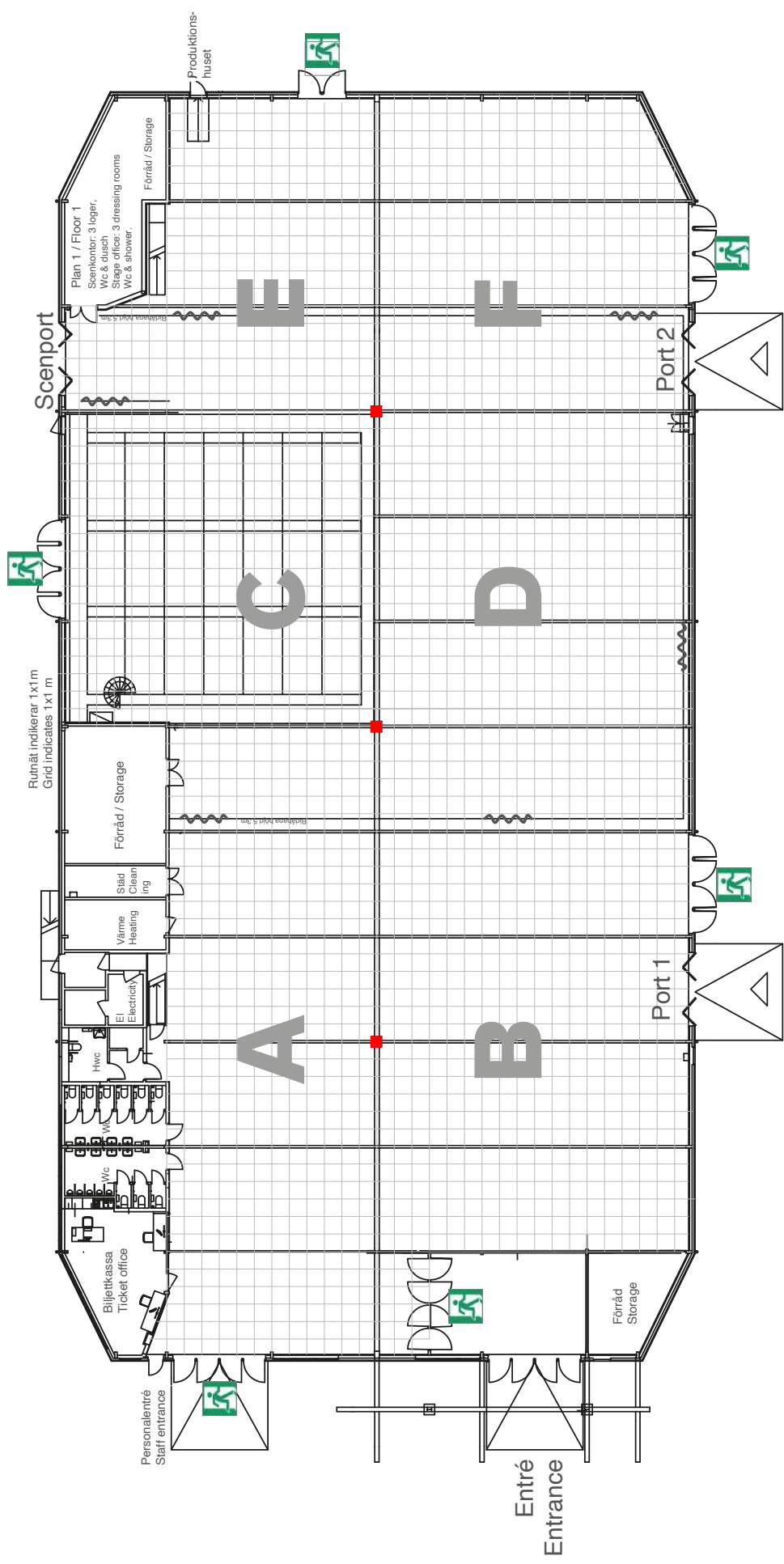

Map of the Hangaren area

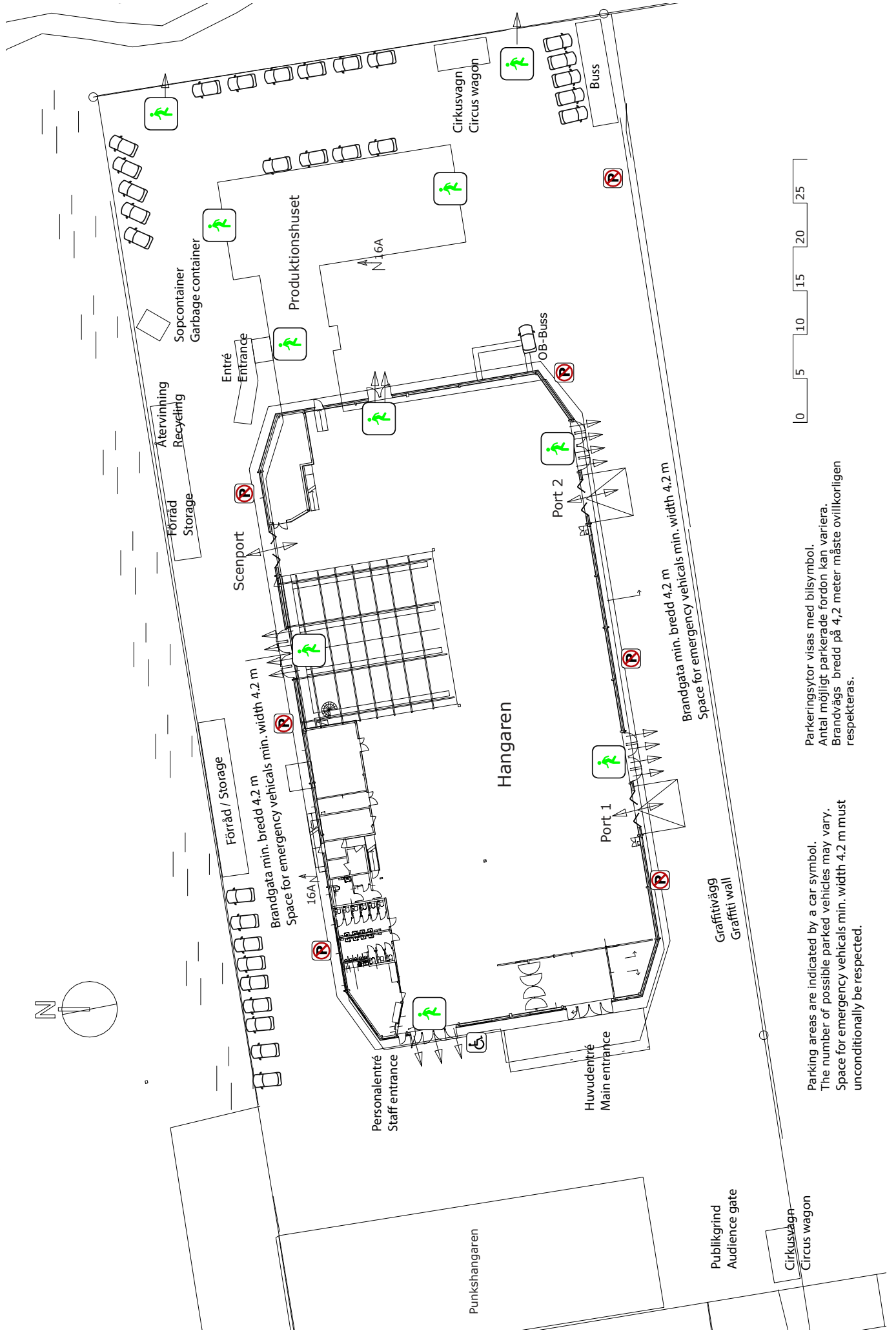

Parking areas are indicated by a car symbol.
 The number of possible parked vehicles may vary.
 Space for emergency vehicals min. width 4.2 m must unconditionally be respected.

Parkeringsytor visas med bilsymbol.
 Antal möjligt parkerade fordon kan variera.
 Brandvägs bredd på 4,2 meter måste ovillkorligen respekteras.